

Pipe Handling Systems

Oil and Gas
Mineral Exploration

DRILL PRODUCTS



Foremost designs and manufactures a series of pipe handling systems to suit your requirements, for safe and efficient handling of tubulars.

Foremost's patented Pipe Handling system has been used on a variety of drilling rigs, in various applications around the world for the past twenty years to greatly increase drilling productivity and safety.



- Semi-automatic mechanical arm
- Directly mounted to the mast
 - Ensures straighter connections
 - Eliminates excessive tool joint thread wear
 - Increases thread life
- Pipe Handling operations are controlled by the driller with no other assistance
 - Less time per connection - typical connection times of less than 45 seconds
- Allows for full torque back up of top drive
 - No additional back up equipment is required for make up or break out
- Compatible with most mast designs
- Capable of handling various lengths, weights and diameters of drill pipe (up to range III)
- Can be used in vertical, angle or horizontal directional drilling applications

FOREMOST

Pipe Handling Systems

Series	400	1500	4000	4000HD
Lifting Capacity	400 lbs	1500 lbs	4000 lbs	4000 lbs
Jaw Range	4 ½"	3 ½" - 10 ¾"*	3 ½" - 10 ¾"	3 ½" - 10 ¾"
Pipe Length Capacity	20'	20'	20'	30'
Breakout Torque Capacity	-	12,000 ft-lbs	12,000 ft-lbs	12,000 ft-lbs
Estimated Weight	1000 lbs	3500 lbs	3800 lbs	3800 lbs

*A special set of jaws are required for larger diameter tubulars up to 10 ¾"

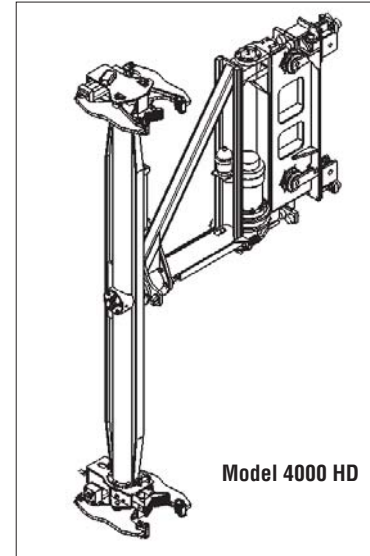
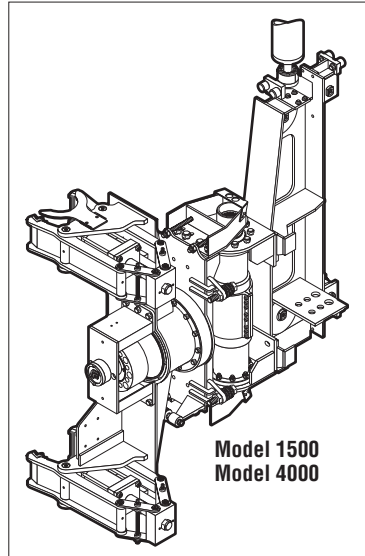
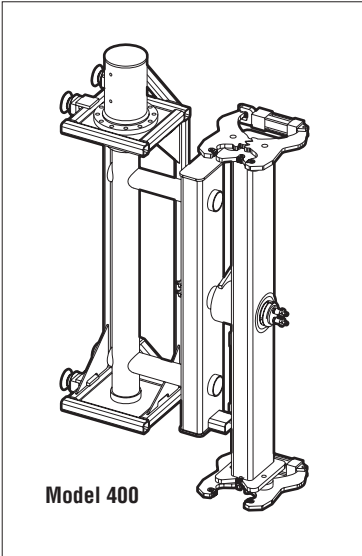

TYPICAL PROCEDURE FOR PIPE HANDLING OPERATION

The Foremost mast-mounted Pipe Handler is designed to initially engage drill pipe from a horizontal position followed by its' clamping jaws. With the pipe firmly clamped, the pipe handler is raised along the length of the mast to a point where it can be rotated in line with the mast angle. The pipe is brought into the mast to a position in line with the top drive and lower pipe connection. The pipe handler is used to stab the downhole tool joint. The top head is then lowered and rotated to make the upper connection. With the upper connection made, the pipe handler is released and returned to the loading position. The top drive is used to torque the lower connection.



Foremost Industries LP

1225 - 64th Avenue NE, Calgary, Alberta, Canada T2E 8P9

Tel: 403-295-5800 • Fax: 403-295-5810 • E-mail: sales@foremost.ca

1-800-661-9190 Canada/U.S.A. • www.foremost.ca

FOREMOST

Unless otherwise stated, specifications are for a standard unit and are subject to change without notice. Performance specifications are theoretical maximums and do not include mechanical or other efficiency losses. Actual performance may vary.